

[Bath]  
BD25 s

informazioni tecniche  
technical details  
données techniques  
technische Daten  
informaciones técnicas  
Page 140-141

[Bath]  
BD25 d

informazioni tecniche  
technical details  
données techniques  
technische Daten  
informaciones técnicas  
Page 142

BD 25





# BD25s

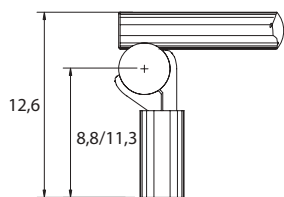

## STBOS

B\* ≤ 90

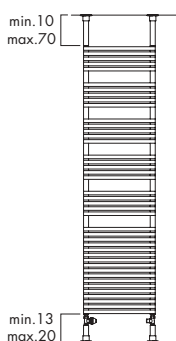

## STBOP

B\* ≤ 60

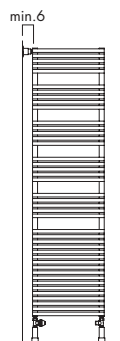

## STBOPV

B\* ≤ 60

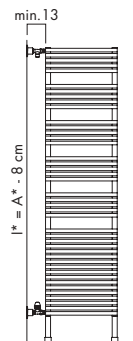

**[A]** attacco standard  
standard connection  
raccord standard  
standard Anschluss  
conexión estándar

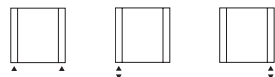

**[B]** attacco speciale  
special connection  
raccord spéciale  
speziell Anschluss  
conexión especial

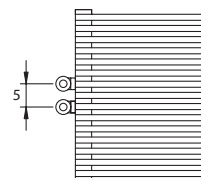

P\* 150

A* cm	in	B* cm	in	l* cm	in	art*	BTU Δt 50°	watt Δt 50°	E* M* ET* MT*
80.0	31.5	40.0	15.7	36.0	14.2	BD25000S080040	1 242	365	350
80.0	31.5	50.0	19.7	46.0	18.1	BD25000S080050	1 552	455	500
80.0	31.5	60.0	23.6	56.0	22.0	BD25000S080060	1 846	541	500
80.0	31.5	70.0	27.6	66.0	26.0	BD25000S080070	2 138	626	
80.0	31.5	80.0	31.5	76.0	29.9	BD25000S080080	2 428	712	
80.0	31.5	90.0	35.4	86.0	33.9	BD25000S080090	2 716	797	
80.0	31.5	100.0	39.4	96.0	37.8	BD25000S080100	3 033	889	
116.0	45.7	40.0	15.7	36.0	14.2	BD25000S116040	1 786	524	500
116.0	45.7	50.0	19.7	46.0	14.2	BD25000S116050	2 209	648	700
116.0	45.7	60.0	23.6	56.0	14.2	BD25000S116060	2 628	771	700
116.0	45.7	70.0	27.6	66.0	14.2	BD25000S116070	3 044	896	
116.0	45.7	80.0	31.5	76.0	14.2	BD25000S116080	3 457	1 014	
116.0	45.7	90.0	35.4	86.0	14.2	BD25000S116090	3 686	1 134	
116.0	45.7	100.0	39.4	96.0	14.2	BD25000S116100	4 276	1 254	
152.0	59.8	40.0	15.7	36.0	14.2	BD25000S152040	2 297	674	700
152.0	59.8	50.0	19.7	46.0	14.2	BD25000S152050	2 842	833	700
152.0	59.8	60.0	23.6	56.0	14.2	BD25000S152060	3 381	992	1000
152.0	59.8	70.0	27.6	66.0	14.2	BD25000S152070	3 916	1 148	
152.0	59.8	80.0	31.5	76.0	14.2	BD25000S152080	4 447	1 304	
152.0	59.8	90.0	35.4	86.0	14.2	BD25000S152090	4 975	1 459	
152.0	59.8	100.0	39.4	96.0	14.2	BD25000S152100	5 501	1 613	
188.0	74.0	40.0	15.7	36.0	14.2	BD25000S188040	2 840	833	700
188.0	74.0	50.0	19.7	46.0	14.2	BD25000S188050	3 449	1 012	1000
188.0	74.0	60.0	23.6	56.0	14.2	BD25000S188060	4 104	1 203	1000
188.0	74.0	70.0	27.6	66.0	14.2	BD25000S188070	4 753	1 394	
188.0	74.0	80.0	31.5	76.0	14.2	BD25000S188080	5 398	1 583	
188.0	74.0	90.0	35.4	86.0	14.2	BD25000S188090	6 039	1 771	
188.0	74.0	100.0	39.4	96.0	14.2	BD25000S188100	6 554	1 922	

art	watt		art	watt	
SOVRES0350	350	<b>E*</b>	SOVRES0350 T	350	<b>ET*</b>
SOVRES0500	500		SOVRES0500 T	500	
SOVRES0700	700		SOVRES0700 T	700	
SOVRES1000	1000		SOVRES1000 T	1000	
KITRES0350	350	<b>M*</b>	KITRES0350 T	350	<b>MT*</b>
KITRES0500	500		KITRES0500 T	500	
KITRES0700	700		KITRES0700 T	700	
KITRES1000	1000		KITRES1000 T	1000	

A\* = altezza / height / hauteur / Höhe / alto    B\* = larghezza / width / longueur / Breite / ancho    art\* = articolo / model / modèle / Artikel / artículo  
 l\* = interasse / pipe centres / distance entre depart et retour / Achsabstand / distancia entre las conexiones    P\* = pagina / page / page / Seite / página  
 E\* = elettrico / electrical / électric / elektrische / eléctrico    M\* = misto / dual application / mixte / der gemischter Ausführung / kit mixto  
 ET\* = elettrico termostato ambiente / thermostat / thermostat / der Thermostat / termostato  
 MT\* = misto termostato ambiente / dual application with thermostat / mixte avec thermostat / der gemischter Ausführung mit Thermostat / kit mixto con termostato



Ulteriori dettagli  
Further details  
Ulérieures détails  
Weitere Einzelheiten  
Otros detalles

P\* 148

Colori / colours / couleurs / Farbe / colores

- [ BIAN ] B standard  
T + 10%  
S + 20%
  - [ RAL ] S + 20%
- RAL non inclusi in tabella  
special Ral colours  
couleurs Ral spéciales  
RAL Farbe nicht in der Tabelle inbegriffen  
colores RAL especiales

Kcal = Watt x 0,860  
BTU = Watt x 3,413

Watt Δt 60° = Watt Δt 50° x 1,238  
Watt Δt 40° = Watt Δt 50° x 0,770  
Watt Δt 30° = Watt Δt 50° x 0,550  
Watt Δt 20° = Watt Δt 50° x 0,342

# BD25s CROM

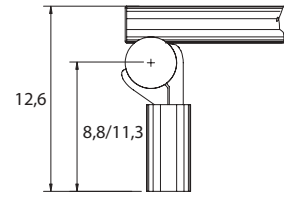

**[A]** attacco standard  
standard connection  
raccord standard  
standard Anschluss  
conexión estándar

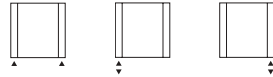

**[B]** attacco speciale  
special connection  
raccord spéciale  
speziell Anschluss  
conexión especial

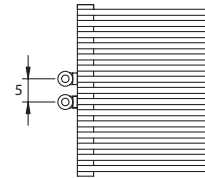

P\* 150

CROM						art*	BTU Δt 50°	watt Δt 50°
A* cm	in	B* cm	in	l* cm	in			
80.0	31.5	40.0	15.7	36.0	14.2	BD25000S080040R	906	265
80.0	31.5	50.0	19.7	46.0	18.1	BD25000S080050R	1 129	331
80.0	31.5	60.0	23.6	56.0	22.0	BD25000S080060R	1 343	393
116.0	45.7	40.0	15.7	36.0	14.2	BD25000S116040R	1 297	380
116.0	45.7	50.0	19.7	46.0	18.1	BD25000S116050R	1 604	470
116.0	45.7	60.0	23.6	56.0	22.0	BD25000S116060R	1 908	559
152.0	59.8	40.0	15.7	36.0	14.2	BD25000S152040R	1 665	488
152.0	59.8	50.0	19.7	46.0	18.1	BD25000S152050R	2 058	603
152.0	59.8	60.0	23.6	56.0	22.0	BD25000S152060R	2 451	718
188.0	74.0	40.0	15.7	36.0	14.2	BD25000S188040R	2 056	602
188.0	74.0	50.0	19.7	46.0	18.1	BD25000S188050R	2 498	732
188.0	74.0	60.0	23.6	56.0	22.0	BD25000S188060R	2 969	870

art	watt		art	watt	
SOVRES0350	350	<b>E*</b>	SOVRES0350 T	350	<b>ET*</b>
SOVRES0500	500		SOVRES0500 T	500	
SOVRES0700	700		SOVRES0700 T	700	
SOVRES1000	1000		SOVRES1000 T	1000	
KITRES0350	350	<b>M*</b>	KITRES0350 T	350	<b>MT*</b>
KITRES0500	500		KITRES0500 T	500	
KITRES0700	700		KITRES0700 T	700	
KITRES1000	1000		KITRES1000 T	1000	

**A\*** = altezza / height / hauteur / Höhe / alto     
**B\*** = larghezza / width / longueur / Breite / ancho     
**art\*** = articolo / model / modèle / Artikel / artículo  
**l\*** = interasse / pipe centres / distance entre depart et retour / Achsabstand / distancia entre las conexiones     
**P\*** = pagina / page / page / Seite / página  
**E\*** = elettrico / electrical / électric / elektrische / eléctrico     
**M\*** = misto / dual application / mixte / der gemischter Ausführung / kit mixto  
**ET\*** = elettrico termostato ambiente / thermostat / thermostat / der Thermostat / termostato  
**MT\*** = misto termostato ambiente / dual application with thermostat / mixte avec thermostat / der gemischter Ausführung mit Thermostat / kit mixto con termostato

Kcal = Watt x 0,860  
 BTU = Watt x 3,413

Watt Δt 60° = Watt Δt 50° x 1,238  
 Watt Δt 40° = Watt Δt 50° x 0,770  
 Watt Δt 30° = Watt Δt 50° x 0,550  
 Watt Δt 20° = Watt Δt 50° x 0,342

Ulteriori dettagli  
 Further details  
 Ulérieures détails  
 Weitere Einzelheiten  
 Otros detalles



P\* 148

# BD25d

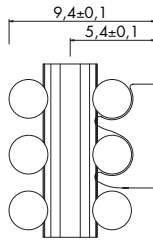

**STBOS**  
B\* ≤ 60

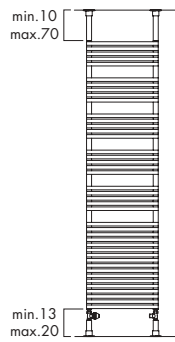

**STBOP**  
B\* ≤ 40

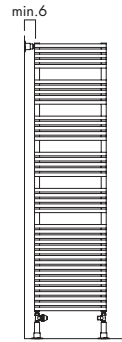

**STBOPV**  
B\* ≤ 40

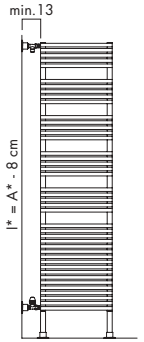

**[A]** attacco standard  
standard connection  
raccord standard  
standard Anschluss  
conexión estándar

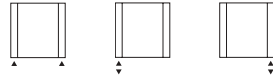

**[B]** attacco speciale  
special connection  
raccord spéciale  
speziell Anschluss  
conexión especial

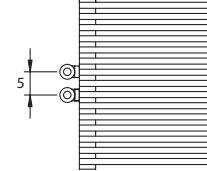

P\* 150

A* cm	in	B* cm	in	l* cm	in	art*	BTU Δt 50°	watt Δt 50°
80.0	31.5	40.0	15.7	36.0	14.2	BD25000D080040	1 918	563
80.0	31.5	50.0	19.7	46.0	18.1	BD25000D080050	2 391	701
80.0	31.5	60.0	23.6	56.0	22.0	BD25000D080060	2 864	840
80.0	31.5	70.0	27.6	66.0	26.0	BD25000D080070	3 336	978
80.0	31.5	80.0	31.5	76.0	29.9	BD25000D080080	3 808	1 117
80.0	31.5	90.0	35.4	86.0	33.9	BD25000D080090	4 276	1 254
80.0	31.5	100.0	39.4	96.0	37.8	BD25000D080100	4 744	1 391
116.0	45.7	40.0	15.7	36.0	14.2	BD25000D116040	2 659	780
116.0	45.7	50.0	19.7	46.0	14.2	BD25000D116050	3 315	972
116.0	45.7	60.0	23.6	56.0	14.2	BD25000D116060	3 975	1 166
116.0	45.7	70.0	27.6	66.0	14.2	BD25000D116070	4 634	1 359
116.0	45.7	80.0	31.5	76.0	14.2	BD25000D116080	5 294	1 552
116.0	45.7	90.0	35.4	86.0	14.2	BD25000D116090	5 953	1 746
116.0	45.7	100.0	39.4	96.0	14.2	BD25000D116100	6 609	1 938
152.0	59.8	40.0	15.7	36.0	14.2	BD25000D152040	3 408	999
152.0	59.8	50.0	19.7	46.0	14.2	BD25000D152050	4 250	1 246
152.0	59.8	60.0	23.6	56.0	14.2	BD25000D152060	5 096	1 495
152.0	59.8	70.0	27.6	66.0	14.2	BD25000D152070	5 946	1 744
152.0	59.8	80.0	31.5	76.0	14.2	BD25000D152080	6 788	1 991
152.0	59.8	90.0	35.4	86.0	14.2	BD25000D152090	7 634	2 239
152.0	59.8	100.0	39.4	96.0	14.2	BD25000D152100	8 480	2 487
188.0	74.0	40.0	15.7	36.0	14.2	BD25000D188040	4 032	1 182
188.0	74.0	50.0	19.7	46.0	14.2	BD25000D188050	5 035	1 477
188.0	74.0	60.0	23.6	56.0	14.2	BD25000D188060	6 039	1 771
188.0	74.0	70.0	27.6	66.0	14.2	BD25000D188070	7 042	2 065
188.0	74.0	80.0	31.5	76.0	14.2	BD25000D188080	8 045	2 359
188.0	74.0	90.0	35.4	86.0	14.2	BD25000D188090	9 052	2 655
188.0	74.0	100.0	39.4	96.0	14.2	BD25000D188100	10 055	2 949

art	watt		art	watt	
SOVRES0350	350	<b>E*</b>	SOVRES0350 T	350	<b>ET*</b>
SOVRES0500	500		SOVRES0500 T	500	
SOVRES0700	700		SOVRES0700 T	700	
SOVRES1000	1000		SOVRES1000 T	1000	
KITRES0350	350	<b>M*</b>	KITRES0350 T	350	<b>MT*</b>
KITRES0500	500		KITRES0500 T	500	
KITRES0700	700		KITRES0700 T	700	
KITRES1000	1000		KITRES1000 T	1000	

**A\*** = altezza / height / hauteur / Höhe / alto    **B\*** = larghezza / width / longueur / Breite / ancho    **art\*** = articolo / model / modèle / Artikel / artículo  
**l\*** = interasse / pipe centres / distance entre depart et retour / Achsstand / distancia entre las conexiones    **P\*** = pagina / page / page / Seite / página  
**E\*** = elettrico / electrical / électric / elektrische / eléctrico    **M\*** = misto / dual application / mixte / der gemischter Ausführung / kit mixto  
**ET\*** = elettrico termostato ambiente / thermostat / thermostat / der Thermostat / termostato  
**MT\*** = misto termostato ambiente / dual application with thermostat / mixte avec thermostat / der gemischter Ausführung mit Thermostat / kit mixto con termostato

<p>Ulteriori dettagli Further details Ulérieures détails Weitere Einzelheiten Otros detalles</p>	<p>Colori / colours / couleurs / Farbe / colores</p> <p>[ BIAN ]    B standard                   T + 10%                   S + 20%</p> <p>[ RAL ]        S + 20%</p> <p>RAL non inclusi in tabella special Ral colours couleurs Ral spéciales RAL Farbe nicht in der Tabelle inbegriffen colores RAL especiales</p>	<p>Kcal = Watt x 0,860 BTU = Watt x 3,413</p> <p>Watt Δt 60° = Watt Δt 50° x 1,264 Watt Δt 40° = Watt Δt 50° x 0,750 Watt Δt 30° = Watt Δt 50° x 0,518 Watt Δt 20° = Watt Δt 50° x 0,307</p>
--	---	--

P\* 148