

Trim

Dimensioni reali / Real dimentions / Dimensions réelles / Die reale Grösse / Dimensiones reales





[Home]

Trim

informazioni tecniche
technical details
données techniques
technische Daten
informaciones técnicas
Page 85-86-87-88

TRIM S

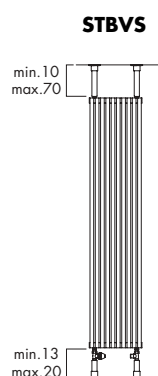
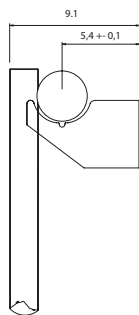
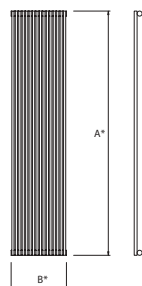

$A^* \geq 180$
 $B^* \leq 90$

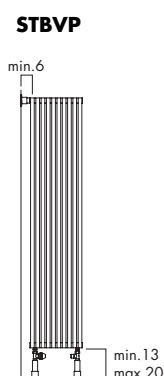

$A^* \geq 40$
 $B^* \leq 60$

[X] attacco standard
standard connection
raccord standard
standard Anschluss
conexión estándar

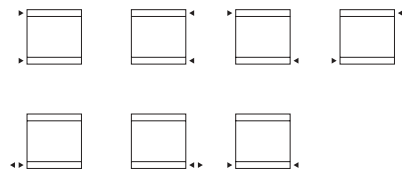

[B] attacco speciale
special connection
raccord spéciale
speziell Anschluss
conexión especial

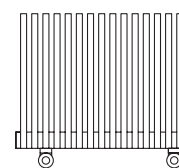

[B5] attacco interasse 5 cm
pipe centres 5 cm
raccords 5 cm
5 cm Achsabstand Anschluss
conexión entre ejes: 5 cm.

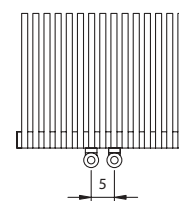

P* 150

A*	L*	min. el.	max el.
60	0.172	10	42
70	0.194	10	42
80	0.216	10	42
100	0.260	10	42
120	0.305	10	42
160	0.393	10	42
170	0.416	10	42
180	0.438	10	42
200	0.482	10	42
220	0.526	10	24

A* = altezza / height / hauteur / Höhe / alto **B*** = larghezza / width / longueur / Breite / ancho **P*** = pagina / page / page / Seite / página
L* = contenuto acqua / content / volume / Inhalt / volumen **R*** = rinforzo / reinforcement / renforcement / Verstärkung / refuerzos

Kcal = Watt x 0,860
BTU = Watt x 3,413

Watt Δt 60° = Watt Δt 50° x 1,273
Watt Δt 40° = Watt Δt 50° x 0,744
Watt Δt 30° = Watt Δt 50° x 0,509
Watt Δt 20° = Watt Δt 50° x 0,297

Colori/ colours / couleurs / Farbe / colores

[BIAN] B standard
T + 10%
S + 20%
[RAL] S + 20%
RAL non inclusi in tabella
special Ral colours
couleurs Ral spéciales
RAL Farbe nicht in der Tabelle inbegriffen
colores RAL especiales

Ulteriori dettagli
Further details
Ulérieures détails
Weitere Einzelheiten
Otros detalles



P* 148

TRIM S

No. el.	A*		60	70	80	100	120	160	170	180	200	220
	B*	I*										
10	24.8	33.8	221	254	286	352	417	543	572	603	664	724
12	29.6	38.6	265	305	343	422	501	651	687	724	797	869
14	34.4	43.4	309	356	401	492	584	760	801	845	930	1 014
16	39.2	48.2	353	406	458	563	668	868	916	966	1 063	1 159
18	44.0	53.0	397	457	515	633	751	977	1 030	1 086	1 196	1 303
20	48.8	57.8	441	508	572	703	834	1 085	1 145	1 207	1 329	1 448
22	53.6	62.6	486	559	630	774	918	1 194	1 259	1 328	1 462	1 593
24	58.4	67.4	530	610	687	844	1 001	1 302	1 374	1 448	1 594	1 738
26	63.2	72.2	574	660	744	914	1 085	1 411	1 488	1 569	1 727	
28	68.0	77.0	618	711	801	985	1 168	1 519	1 603	1 690	1 860	
30	72.8	81.8	662	762	859	1 055	1 252	1 628	1 717	1 810	1 993	
32	77.6	86.6	706	813	916	1 126	1 335	1 736	1 832	1 931	2 126	
34	82.4	91.4	750	864	973	1 196	1 419	1 845	1 946	2 052	2 259	
36	87.2	96.2	794	914	1 030	1 266	1 502	1 953	2 061	2 172	2 392	
38	92.0	101.0	839	965	1 088	1 337	1 586	2 062	2 175	2 293	2 525	
40	96.8	105.8	883	1 016	1 145	1 407	1 669	2 170	2 290	2 414	2 657	
42	101.6	110.6	927	1 067	1 202	1 477	1 752	2 279	2 404	2 534	2 790	

I*	56 cm	66 cm	76 cm	96 cm	116 cm	156 cm	166 cm	176 cm	196 cm	216 cm

TRIM D

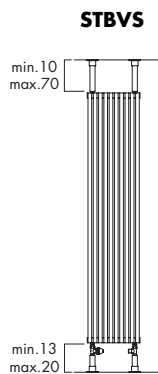
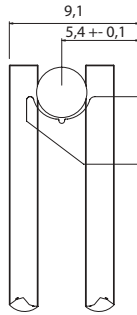
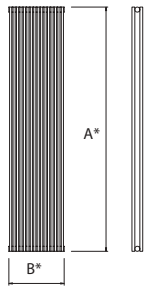

$A^* \geq 180$
 $B^* \leq 60$

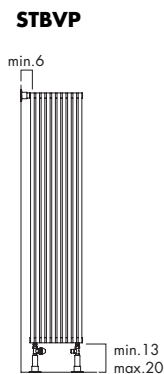

$A^* \geq 40$
 $B^* \leq 40$

[X] attacco standard
standard connection
raccord standard
standard Anschluss
conexión estándar

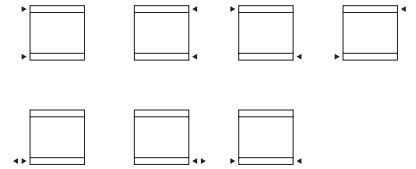

[B] attacco speciale
special connection
raccord spéciale
speziell Anschluss
conexión especial

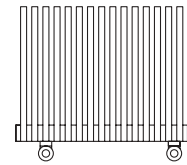

[B5] attacco interasse 5 cm
pipe centres 5 cm
raccords 5 cm
5 cm Achsabstand Anschluss
conexión entre ejes: 5 cm.

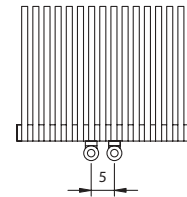

P* 150

A*	L*	min. el.	max el.
60	0.305	10	42
70	0.349	10	42
80	0.393	10	42
100	0.482	10	42
120	0.571	10	42
160	0.748	10	42
170	0.793	10	42
180	0.837	10	42
200	0.926	10	42
220	1.014	10	24

A* = altezza / height / hauteur / Höhe / alto **B*** = larghezza / width / longueur / Breite / ancho **P*** = pagina / page / page / Seite / página
L* = contenuto acqua / content / volume / Inhalt / volumen **R*** = rinforzo / reinforcement / renforcement / Verstärkung / refuerzos

Kcal = Watt x 0,860
BTU = Watt x 3,413

Watt Δt 60° = Watt Δt 50° x 1,282
Watt Δt 40° = Watt Δt 50° x 0,737
Watt Δt 30° = Watt Δt 50° x 0,498
Watt Δt 20° = Watt Δt 50° x 0,286

Colori/ colours / couleurs / Farbe / colores

[BIAN] B standard
T + 10%
S + 20%
[RAL] S + 20%
RAL non inclusi in tabella
special Ral colours
couleurs Ral spéciales
RAL Farbe nicht in der Tabelle inbegriffen
colores RAL especiales

Ulteriori dettagli
Further details
Ulérieures détails
Weitere Einzelheiten
Otros detalles



P* 148

TRIM D
Watt Δt 50°

No. el.	A* / B*		I*	60	70	80	100	120	160	170	180	200	220
	A*	B*											
10	24.8	33.8	33.8	333	384	433	531	626	814	859	905	994	1 084
12	29.6	38.6	38.6	400	461	520	637	752	977	1 030	1 086	1 193	1 301
14	34.4	43.4	43.4	467	537	607	743	877	1 139	1 202	1 266	1 392	1 517
16	39.2	48.2	48.2	533	614	693	850	1 002	1 302	1 374	1 447	1 591	1 734
18	44.0	53.0	53.0	600	691	780	956	1 128	1 465	1 546	1 628	1 790	1 951
20	48.8	57.8	57.8	667	768	867	1 062	1 253	1 628	1 717	1 809	1 989	2 168
22	53.6	62.6	62.6	733	845	953	1 168	1 378	1 790	1 889	1 990	2 187	2 385
24	58.4	67.4	67.4	800	921	1 040	1 274	1 503	1 953	2 061	2 171	2 386	2 601
26	63.2	72.2	72.2	867	998	1 127	1 381	1 629	2 116	2 232	2 352	2 585	
28	68.0	77.0	77.0	933	1 075	1 213	1 487	1 754	2 279	2 404	2 533	2 784	
30	72.8	81.8	81.8	1 000	1 152	1 300	1 593	1 879	2 441	2 576	2 714	2 983	
32	77.6	86.6	86.6	1 067	1 229	1 387	1 699	2 005	2 604	2 748	2 895	3 182	
34	82.4	91.4	91.4	1 133	1 305	1 473	1 806	2 130	2 767	2 919	3 076	3 380	
36	87.2	96.2	96.2	1 200	1 382	1 560	1 912	2 255	2 930	3 091	3 257	3 579	
38	92.0	101.0	101.0	1 267	1 459	1 647	2 018	2 380	3 092	3 263	3 437	3 778	
40	96.8	105.8	105.8	1 333	1 536	1 733	2 124	2 506	3 255	3 434	3 618	3 977	
42	101.6	110.6	110.6	1 400	1 612	1 820	2 230	2 631	3 418	3 606	3 799	4 176	

I*	56 cm	66 cm	76 cm	96 cm	116 cm	156 cm	166 cm	176 cm	196 cm	216 cm